

## SJS-1650 Soap Dispenser DISCONTINUED

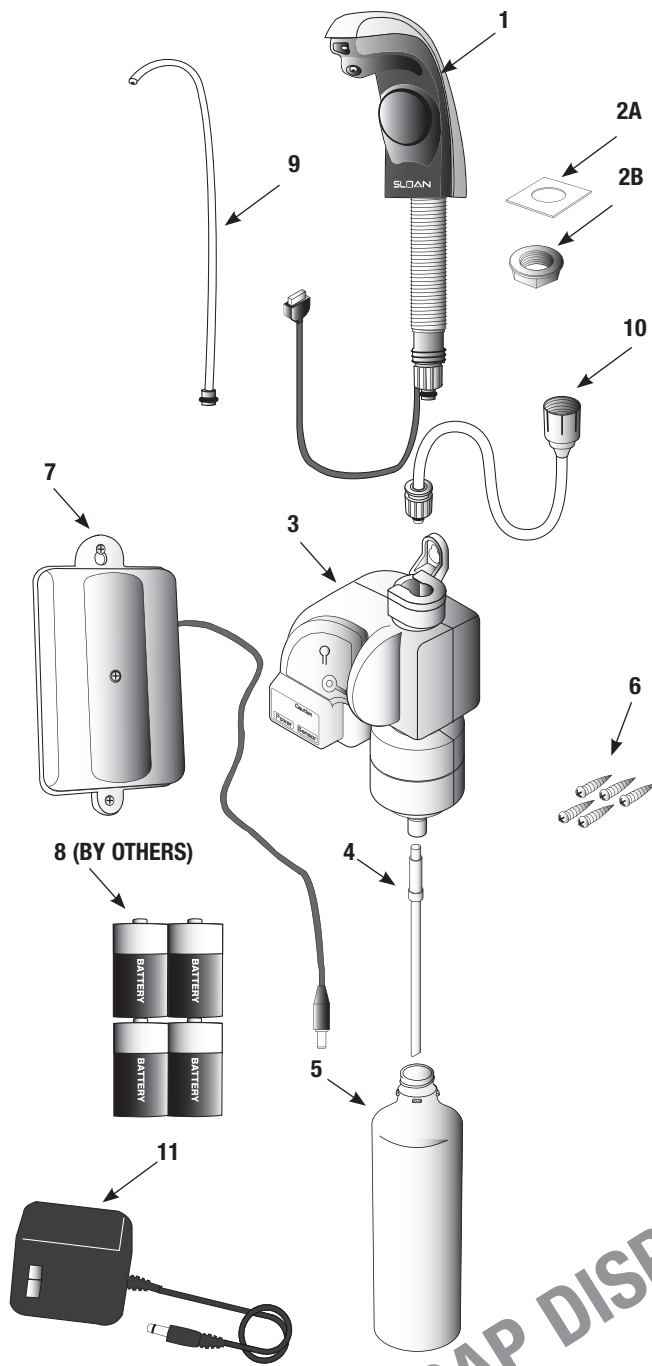

Item No.	Part No.	Description
1.	SJS-1-A	Spout Assembly
2A.	—	Rubber Gasket
2B.	—	Flange Nut
3.	SJS-5	Motor Assembly
4.	SJS-8	Pick-up Tube
5.	SJS-1651	Soap Bottle (sold separately)
6.	—	Mounting Screws (5)
7.	SJS-4	Battery Compartment
8.	—	D-size Alkaline Batteries (4) (supplied by others)
9.	SJS-2	Repair Kit Tube Assembly Soap Path
10.	SJS-3	Repair Kit Tube Assembly Extension
11.	SJS-7	Optional AC Adapter (sold separately)

### CARE AND CLEANING OF CHROME AND SPECIAL FINISHES

DO NOT use abrasive or chemical cleaners (including chlorine bleach) to clean Soap Dispenser that may dull the luster and attack the chrome or special decorative finishes. Use ONLY mild soap and water, then wipe dry with clean cloth or towel.

While cleaning the bathroom tile, protect the Flushometer from any splattering of cleaner. Acids and cleaning fluids will discolor or remove chrome plating.

### TROUBLESHOOTING GUIDE

#### 1. Yellow LED light is flashing.

- A. Soap level is low. Check level and change as needed.
- B. Reset button was not pressed after the refill was installed. Press and release reset button.

#### 2. Red LED light is flashing (battery power only).

- A. Batteries are low. Replace with four (4) new D-size alkaline batteries.

#### 3. Soap does not dispense.

- A. Check that power source is plugged in correctly.
- B. Make sure batteries have been properly installed in the battery compartment.
- C. Check soap path for clogging. Remove and replace as needed.

#### 4. Soap does not dispense when user "waves" their hands under the spout.

- A. Hands must be held steady under the spout for soap to be dispensed.

#### 5. Dispenser rotates due to users moving the spout.

- A. Tighten the existing flange nut on the shank of the spout under the counter.
- B. Add a second flange nut from Sloan JanSan to act as a jam nut in conjunction with the nut already installed.

DISCONTINUED SOAP DISPENSER